

*In the heart of the millenium city of Montpellier*

*Welcome to Montpellier*



**MONTPELLIER FRANCE**



# *An exceptional lifestyle...*



300 days of sunshine per year



An elegant city, old and new



Montpellier's elegant historic and pedestrian centre is a myriad of little streets, full of shops, restaurants, parks and gardens



## MONTPELLIER FRANCE





## *A centre of art and culture*

Vibrant, active and lively, summer and winter, morning, noon and night.  
The renowned Radio France Music Festival and the Montpellier Dance Festival, the International Festival of Mediterranean Film...

The Fabre museum, two opera houses, a rich historical center with gardens, the St Pierre Cathedral, the French oldest Faculty of Medicine created in 1220...

## *Bounded by both mountains and sea*



Ten minutes to get to 100 miles of Mediterranean beaches

## *The region's magnificent vineyards*

Considerable improvements have been made in the quality of Languedoc-Roussillon wines: many have achieved AOC status and are sought by connoisseurs worldwide



# MONTPELLIER FRANCE



# *A rich scientific environment*

- Research facilities in various scientific disciplines: Physics, Chemistry, Materials, Sciences...
- Medical research: The CHU of Montpellier is one of the most important in France in number of medical research projects
- Life sciences, Agricultural sciences and Plant biotechnology
- New Information Technologies



MONTPELLIER FRANCE





# Agropolis International Association assembles:

## Research institutes

- **Bioversity International**  
Banana Section
- **BRGM**  
Géosciences pour une terre durable
- **CEA**  
Recherche, développement et innovation en matière d'énergie, de défense, de technologies de l'information et de santé
- **Cemagref**  
La recherche pour l'ingénierie de l'agriculture et de l'environnement
- **Cirad**  
Centre de Coopération Internationale en Recherche Agronomique pour le Développement
- **CNRS**  
Centre National de la Recherche Scientifique
- **CSIRO**  
CSIRO European Laboratory • Commonwealth Scientific and Industrial Research Organisation Division of Entomology (Australia)
- **Embrapa**  
Empresa Brasileira de Pesquisa Agropecuária (Brazil)
- **Ifremer**  
Institut français de recherche pour l'exploitation de la mer
- **Inra**  
Institut National de la Recherche Agronomique
- **IRD**  
Institut de Recherche pour le Développement
- **USDA**  
European Biological Control Laboratory USDA-ARS (United States Department of Agriculture-Agricultural Research Service, USA)

## Local authorities

- Région Languedoc-Roussillon
- Conseil général de l'Hérault
- Montpellier Agglomération
- Ville de Montpellier

## Associate members

- Bio Obtention ■ BRL ■ CADE
- CODIGE ■ Crédit Agricole du Midi
- FIDES ■ Graines d'Idée ■ IBMA
- ITK ■ Maproc ■ Parc national des Cévennes

## Training and research institutes

- **AgroParisTech / ENGREF**  
École Nationale du Génie Rural des Eaux et des Forêts
- **Ciheam/IAM.M**  
Centre International de Hautes Études Agronomiques Méditerranéennes / Institut Agronomique Méditerranéen de Montpellier
- **ESCAIA**  
École Supérieure de la Coopération Agricole et des Industries Agro Alimentaires
- **Icra**  
Centre International pour la Recherche Agricole orientée vers le développement
- **Istom**  
École d'Ingénieur Agro Développement International
- **Montpellier SupAgro**  
Centre international d'études supérieures en sciences agronomiques
- **UM1, UM2, UM3**  
Universités Montpellier 1, 2 et 3
- **UNimes**  
Université de Nîmes
- **UP Via Domitia**  
Université de Perpignan Via Domitia
- **Sup de Co**  
Groupe Sup de Co Montpellier

## Partners of the economic development

- **ACTA**  
Association de Coordination Technique Agricole
- **ACTIA**  
Association de Coordination Technique pour l'Industrie Agroalimentaire
- **ARIA LR**  
Association Régionale des Industries Agro-Alimentaires du Languedoc Roussillon
- **CCI de Montpellier**  
Chambre de Commerce et d'Industrie de Montpellier
- **LRI**  
Languedoc-Roussillon Incubation
- **Transferts LR**  
Transfert de technologie et savoir-faire innovants en Languedoc-Roussillon
- **VERSeau Développement**  
Valorisation des Études et des Recherches dans les Sciences de l'Eau



**AGROPOLIS**  
INTERNATIONAL

Montpellier Languedoc-Roussillon  
World centre for agricultural,  
food and environmental sciences

Avenue Agropolis  
F-34394 Montpellier CEDEX 5  
Tel.: +33 (0)4 67 04 75 75  
Fax.: +33 (0)4 67 04 75 99  
e-mail: [agropolis@agropolis.fr](mailto:agropolis@agropolis.fr)  
[www.agropolis.fr](http://www.agropolis.fr)

financial support from



Assembles  
the **largest scientific  
community** in its field

At the heart of international  
networks for **scientific  
cooperation**

For all the stakeholders involved  
in **agricultural research,  
training and development**

**AGROPOLIS**  
INTERNATIONAL

Montpellier Languedoc-Roussillon  
World centre for agricultural,  
food and environmental sciences

[www.agropolis.fr](http://www.agropolis.fr)

Further information: [www.agropolis.fr/about](http://www.agropolis.fr/about)



## Key figures

■ **24 research and higher education institutions**

■ **2300 research scientists and lecturers** including 500 persons with long-term assignments in some 60 partner countries

■ **112 inter-institutional and inter-disciplinary units**

■ **10 foreign laboratories and international networks**

■ **9 campuses with high-performance facilities:** Maison de la Télédétection, Maison de la Technologie, Maison des Sciences de l'Eau, Ecotron, Génopole, experimental greenhouses, pilot plants, business innovation centres, etc.

■ **Agropolis Fondation:** to support scientific innovation in order to tackle the major issues related to sustainable development

■ **2 competitiveness clusters:** Q@LI-MEDiterranée, Risk and vulnerabilities management of territories

■ Access to **43 libraries**

■ **7000 students and trainees**

■ **80 degrees** (2 to 8 years of higher education: technician, ingénieur, BSc, MSc, PhD)

■ **100 pre-existing professional training modules**, customised courses, etc.

■ Available in **5 universities** and **7 Ecoles d'Ingénieurs** and **Grandes Ecoles**



At the heart of the scientific community of **Montpellier** and the **Languedoc-Roussillon region (France)**

the world's greatest concentration of skills and expertise in fields related to agriculture, food, biodiversity, environment and rural societies, open to the development of the **Mediterranean and tropical regions.**

mediterranean and tropical regions

At the heart of the scientific community of Montpellier and the Languedoc-Roussillon region

expertise  
A broad range of **expertise...**

- Integrative biology
- Biodiversity and environment
- Water and environment
- Aquatic ecosystems
- Natural and cultivated ecosystems functioning and engineering
- Vine and wine
- Animal production and health
- Ecotechnologies
- Integrated food sciences and techniques
- Information sciences and technology
- Economic, human and social sciences for development

research  
...focusing on the **main research themes** related to **major social issues**

- Biotechnologies and agro-food technologies
- Food production and agro-business
- Food, nutrition and health
- Management of resources and environment and sustainable development
- Territories risk and vulnerability
- Innovation, sustainable development and societies

training  
A comprehensive and diversified **training offer**

- University degrees, professional or research-oriented
- Professional continuing training, short or long courses, with or without diploma
- Training system engineering to meet institutional requests and to support partners
- E-learning, participation in the open university « *Université Ouverte Montpellier Languedoc-Roussillon* » (UO-MLR)



At the heart of the scientific community of Montpellier and the Languedoc-Roussillon region (France)

Agropolis International, **an association founded and governed** by the **institutions** of the **scientific community**

 **agropolis** fondation

A new tool to support the development of research and training-through-research programmes, at international level

[www.agropolis-fondation.fr](http://www.agropolis-fondation.fr)

gateway  
A **gateway** that provides:

- An **easier access** to
  - the expertise of the community
  - documentary resources
  - information
- A **visitors service**
  - "Mobility Centre" for visiting researchers and professors
  - organisation of visits for national and international delegations, meetings, events, congresses...

A **go-between** and a **support** for **common projects**

- promotion, coordination and management of inter-institutional projects with international scope
- interface with the actors of the economic development

facilitation  
A centre for **management** and **facilitation** of projects

pilote platform  
A **pilot platform** to set up **inter-institutional partnerships** and **new organisation methods**

Agropolis International Association works for the scientific community



# High performance infrastructures

Montpellier is extremely well served by advanced, integrated and uncongested transport networks, including **high speed road and rail**, and an **airport fast access**.

## AIR

**14 destinations** served by Montpellier airport

- Paris: 15 to 20 daily flights (flytime: about 1h)
- London Gatwick
- London Stansted
- Frankfurt Hahn
- Madrid

*traditional and low cost airlines*

## RAIL

France's railway infrastructure is one of Europe's finest  
 3<sup>1/4</sup> hours away from Paris by direct high speed train (TGV)  
 15 daily schedule trains

## ROAD

Direct motorway links to European cities



# MONTPELLIER FRANCE

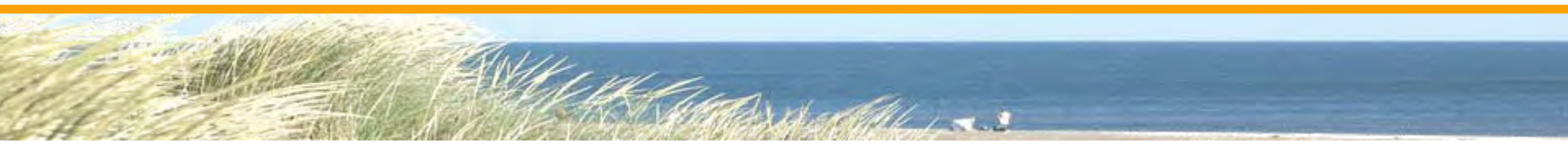

# Urban Transportation system...

## The Tramway

Southern France's first tramway enables rapid and inexpensive cross-city travel.

Many tram stations are integrated with bus services and park-and-ride schemes.



*The tramway*

# Quality Hotels...

With more than **4,300 hotel rooms** customers have a wide range of choice of quality and price.

Montpellier itself has some 2,900 hotel rooms, **with 1,000 rooms within five to ten minutes of the Corum Conference and Cultural Center.**



*One of Montpellier's hotels*

## MONTPELLIER FRANCE





## Prices range by category

Categories		<i>Mini / maxi in euros</i>
4 stars	<i>1 person</i>	180 / 200
	<i>2 persons</i>	200 / 220
3 stars Hotel	<i>1 person</i>	100 / 120
	<i>2 persons</i>	130 / 140
2 stars	<i>1 person</i>	70 / 80
	<i>2 persons</i>	90 / 100



Categories	<i>Nber of rooms</i>
4 *	186
3 *	2096
2 *	1796
1*	500
<b>Total</b>	<b>4 582</b>

# MONTPELLIER FRANCE



## Le Corum, the experience and the facilities for the success of your event

### *Conference Centre and Opera House in the heart of Montpellier*

Whether for 50 or 4,000 participants, the Corum Conference Centre - Berlioz Opera House is the ideal site for your annual general meeting with its highly efficient organisation, and a wide range of interesting sites and tourist attractions within easy reach.



### *Le Corum Quality Commitments*



LE CORUM has developed a service commitments policy and obtained the certifications:

- AFAQ Service Confiance®
- ISO 9001 since 2003 by AFAQ, the leading certification body in France and 5<sup>th</sup> world-wide.

The ISO 9001 standard is the international business reference as regards certification of quality management systems.

## MONTPELLIER FRANCE

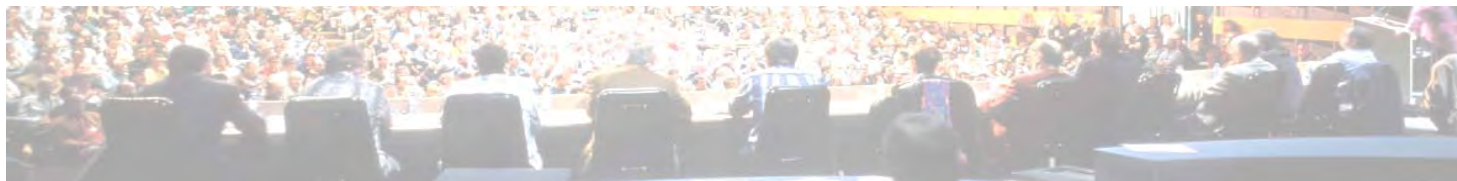



# 20 committee rooms



*Antigone 1 Committee Room*

- well furnished with tables and chairs, or armchairs with integral writing desks
- can be adapted for small conferences (seating 35 to 200)
- as lecture rooms (seating 36 to 144)
- in long table form (seating 24 to 72)

**MONTPELLIER FRANCE**



# The exhibition

6,000 sq meters of exhibition areas which can be divided into modules:

- Esplanade lounges: 1,680 sq meters
- Antigone area: 1,440 sq meters
- Joffre area: 1,100 sq meters
- Berlioz hall: 1,160 sq meters

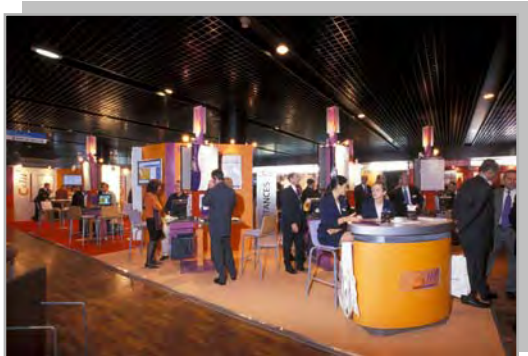

MONTPELLIER FRANCE

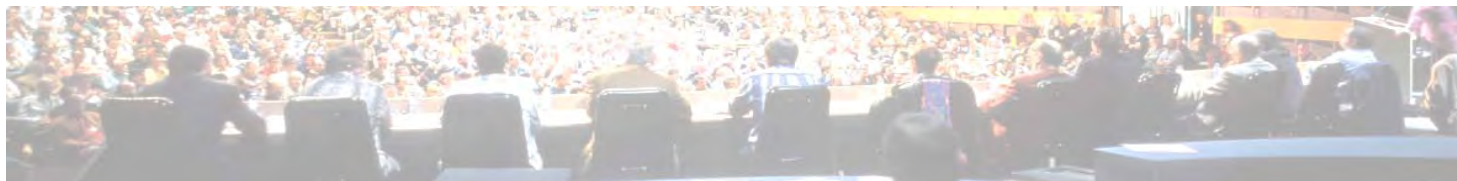



# Catering area : the lounges

## Catering area: the lounges

Highly suitable for business lunches and dinners, gala evenings and cocktail parties, the upper level has an area of 1,680 Sq meters, can be set up for up to 1 000 meals.



*Corum's Brasserie*



*The lounge level 3*

## Brasserie

3 dining rooms and an open-air terrace, seating a total of 250 persons (340 with the open-air terraces)

**MONTPELLIER FRANCE**

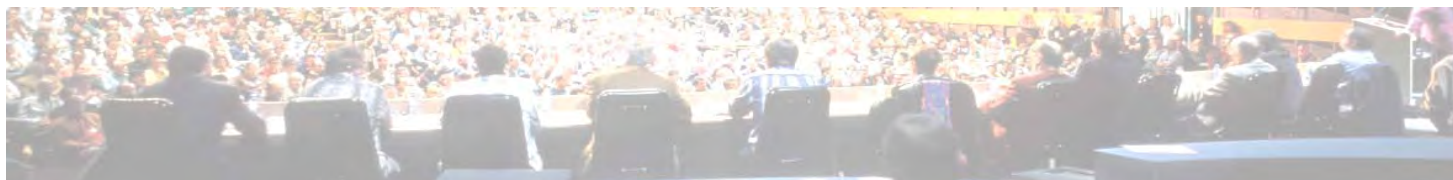



Corum  
Salles des Congrès - Opéra Berlioz

du Niveau 1

Niveau 1

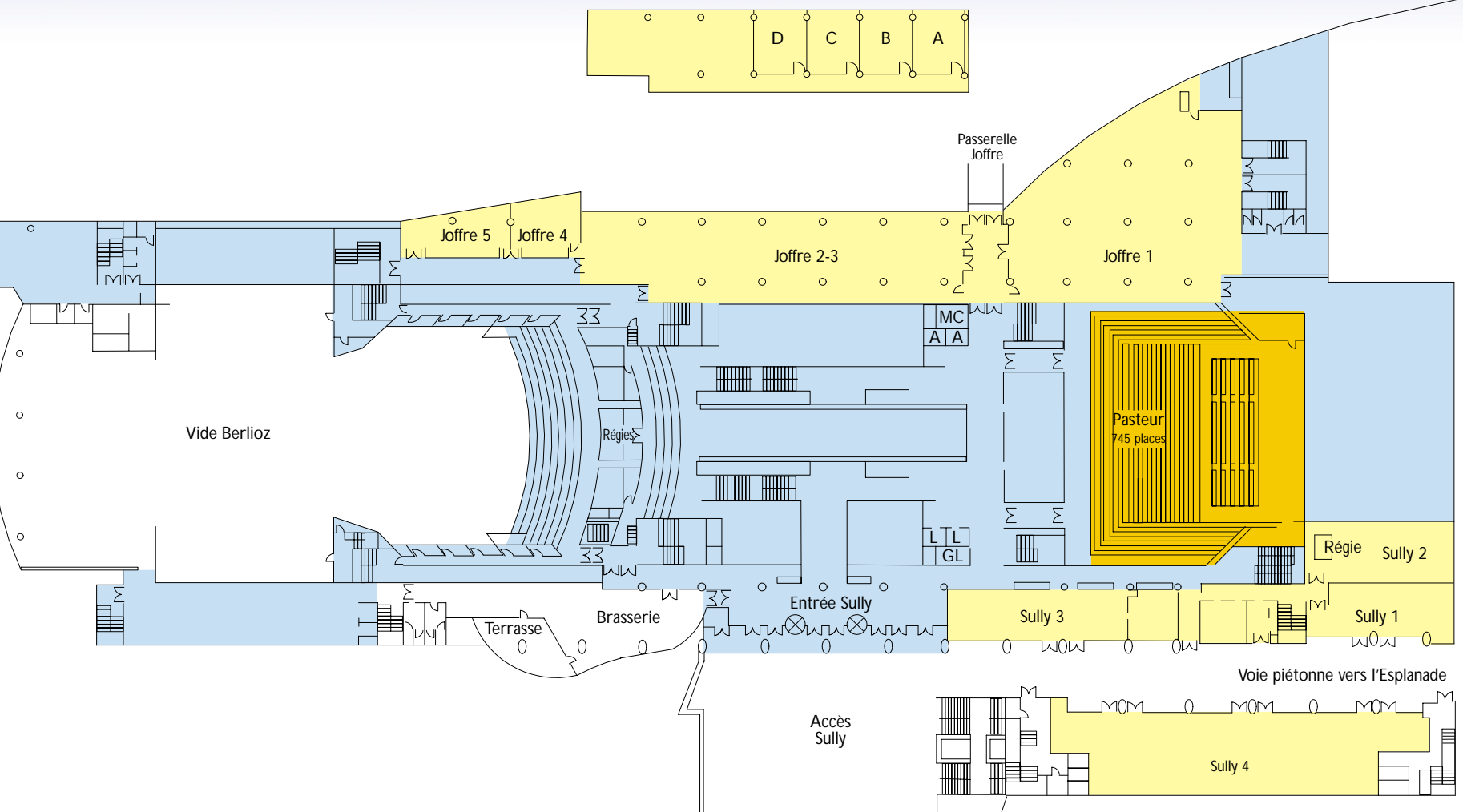



# Niveau 3



Corum  
Salles des Congrès - Opéra Berlioz

Plan du Niveau 3

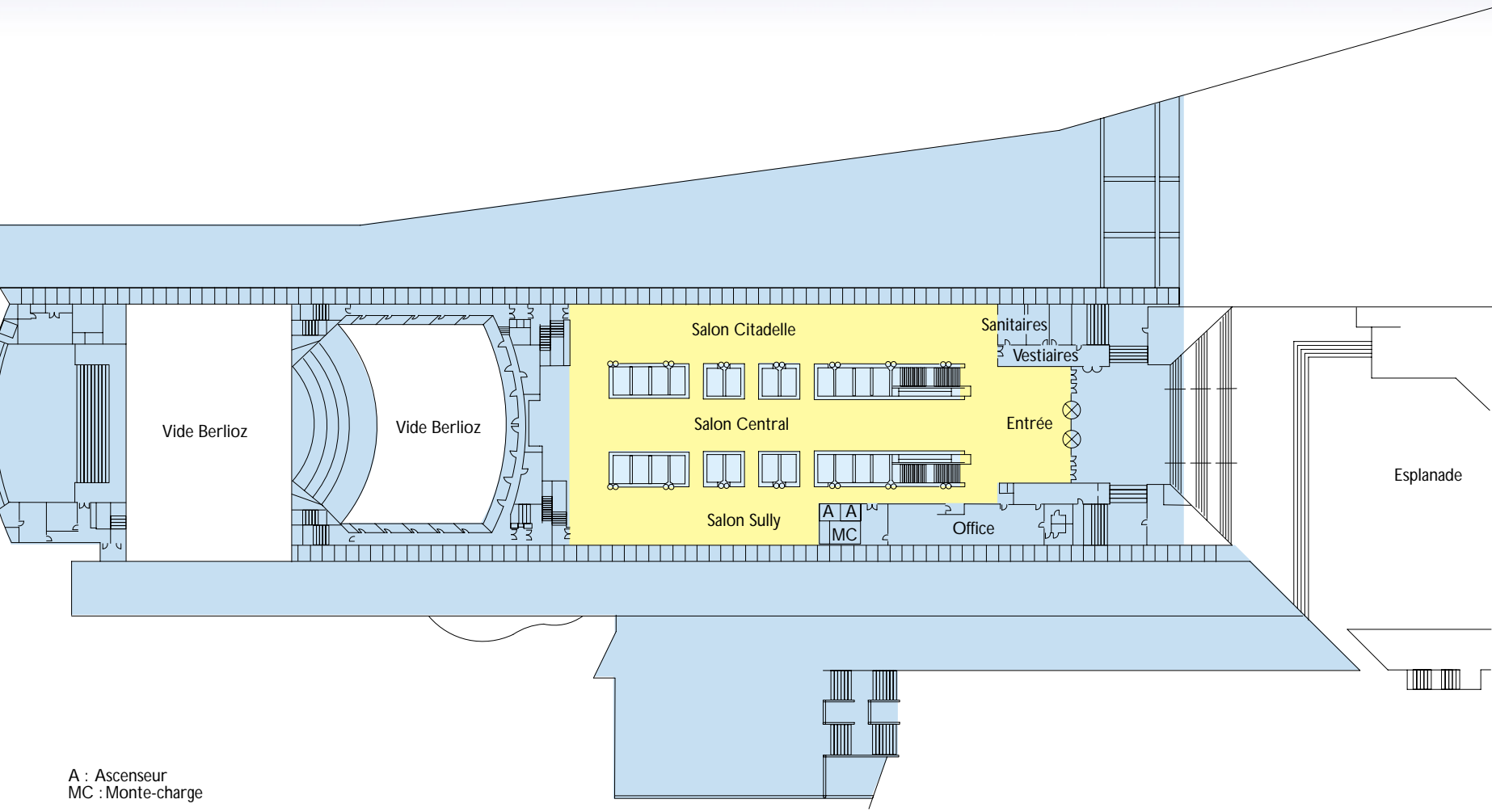

A : Ascenseur  
MC : Monte-charge

s - Opéra Berlioz

né,  
offre un  
éable et  
impeccable.  
rez aussi pour  
ouverts de  
de tablettes.

s : 113 cm  
cm



## Description générale

<b>Capacité</b>	318 sièges
<b>Foyer</b>	160 m <sup>2</sup>
<b>Accès</b>	Accès public Hall Berlioz, niveau 0 (2,05 m largeur x 2 m hauteur) 1 accès conférencier latéral à la scène
<b>Spécifications</b>	Salle disposée en amphithéâtre Principaux matériaux utilisés : bois, moquette Fauteuils en cuir noir à tablettes, numérotés
<b>Scène</b>	Surface de scène : 61 m <sup>2</sup> - largeur : 14,90 m - profondeur : 4 m Charge au sol : 300 kg/m <sup>2</sup> 2 loges latérales
<b>Annexes</b>	3 bureaux / salons VIP

*La location de la salle comprend l'assistance d'un technicien son en régie, sonorisation de la salle, 3 micros de scène, éclairage général, climatisation, nettoyage.*

## Moyens Techniques

<b>Régies</b>	1 régie centrale son / lumière / projection
<b>Eclairage</b>	De salle et de scène, intensité variable
<b>Sonorisation</b>	Générale Congrès - Allen-Heath GL 4000-824 Interphonie technique
<b>Projections</b>	<b>Cinéma</b> Ecran non transonore Distance de projection : 19 m Dimensions de l'écran : 8 x 3,40 m Films 16 et 35 mm en poste simple <b>Diapositives</b> 24 x 36 Projecteurs 400 Watts <b>Vidéo</b> Ecran vidéo non transonore (4 x 3 - 6 x 4,5 - 8 x 3,4) VHS, SVHS, U. Matic (PAL, SECAM, NTSC), BVU, BVUSP, BETA, BETA SP, BETA Equipement : BARCO 9200 REALITY, BARCO 6 400 Vidéo transmission, visioconférence Transmission simultanée entre les auditoriums et appariement vidéo de vo



318 sièges



# The Corum services

As Le CORUM has managed some 200 events a year since 1989, we can provide a highly experienced team to help handle all your logistical problems. Le CORUM has proven and certified excellence in customer service: **You can thus concentrate on the essential : the actual contents of your event.**

From hiring a room to providing every service you need for a successful conference:

- **Event organisation**
- **MANAGEMENT OF HOTEL BOOKINGS**
- **MANAGEMENT OF CONGRESS PARTICIPANTS**
- **Management of exhibitions**
- **Technical services**

**The “Enjoy Montpellier Pass”.** This combines a range of services to help conference members find out more about the city (guided tour), move around (transport card), practise a sport (entry to the Végapolis ice rink and the Olympic Pool), amuse themselves (entry to the Planetarium, Musée Fabre pavilion, etc.) and enjoy the city’s friendly atmosphere (free aperitif in one of our partner restaurants).



## MONTPELLIER FRANCE

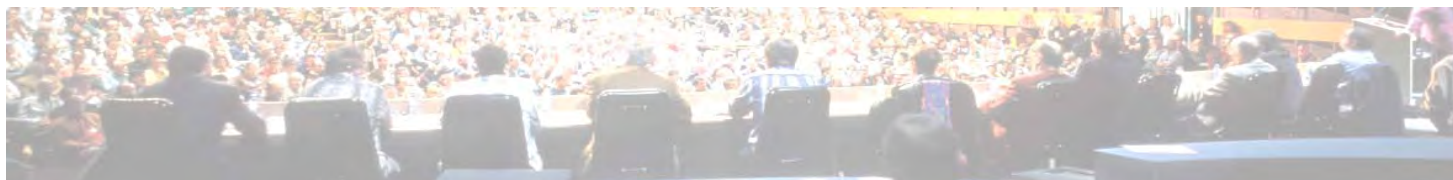

# Useful Links

## Location informations :

- Enjoy Montpellier : <http://www.enjoy-montpellier.com>
- City of Montpellier : <http://www.montpellier.fr/>
- Tourist office : <http://www.ot-montpellier.fr/en/>
- Languedoc-Roussillon (region) : <http://www.tourisme-languedoc-roussillon.com/index.php3?langue=en>

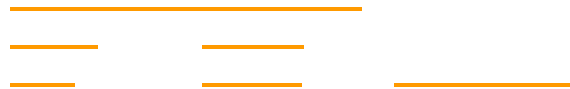

## Transport informations.

- SNCF (Rail) : <http://www.voyages-sncf.com>
- Montpellier airport : [http://www.montpellier.aeroport.fr/layer\\_en.asp?nav=0\\_0\\_0](http://www.montpellier.aeroport.fr/layer_en.asp?nav=0_0_0)  
TAM (bus, tramway) : [http://www.montpellier-agglo.com/tam/page\\_en.php?id\\_rubrique=14](http://www.montpellier-agglo.com/tam/page_en.php?id_rubrique=14)

MONTPELLIER FRANCE

